

Exploded View

ALT Alternator

Assemblies

No.	Description	Part No.	ALT-5101A	ALT-5102S	ALT-8403	ALT-8404	ALT-8404S	ALT-8407	ALT-8420	ALT-8421	ALT-8421S	ALT-9405	ALT-9422	
1	Rotor Assembly	ALT-2006	•	•										
		90-2397 (e)			•	•	•	•						
		ALU-2128S-1								•	•	•		
		90-2398(e)											•	
		ALU-2138S-1												•
2	Brush Set	ALE-1012LS(b)	•											
		ALB-1013BS(b)		•										
		ALE-1013AS							•	•	•		•	
3	Brush Holder & Spring Assy.	ALU-1045BS(c)			•	•	•	•				•		
		ALU-1045BS(c)							•	•	•		•	
4	Slip Ring End Head Assy.	ALH-1002CS	•											
		ALH-1002DS		•										
		90--2397(e)			•	•	•	•						
		ALK-1132AS-1							•	•	•			
		90-2398(e)											•	
		ALE-1142AAS-1												•
5	SRE Bearing	X-3417	•	•										
		90-2014(a)			•	•	•	•	•	•	•	•	•	
6	Drive End Head Assy.	ALE-1033	•	•										
		ALE-1003K			•	•	•	•	•	•	•			
		ALU-1043(d)											•	•
7	DE Bearing	X-5077	•	•										
		X-3416			•	•	•	•	•	•	•			
		X-4087											•	•
8	Stator Assembly	ALE-2008r	•	•										
		ALE-2008AA			•	•	•	•	•	•	•	•	•	
9	Positive Rec. & Plate Assy.	ALE-1004	•	•										
		ALE-1054A	•	•	•	•	•	•	•	•	•	•	•	
10	Negative Rec. (Pkg. Of 3)	XA-944JS	•	•	•	•	•	•	•	•	•	•	•	
11	Terminal Stud Pkg.	90-2359	•											
		90-990		•										
		90-2043			•				•	•			•	•
		90-2030				•	•				•	•		
12	DE Retainer	GGW-91	•	•										
		GR-32			•	•	•	•	•	•	•	•	•	
13	Thru Bolt Pkg.	ALA-20ES	•	•										
		ALA-20GS			•	•	•	•	•	•	•	•	•	
14	Eyelet Pkg.	90-818	•	•	•	•	•	•	•	•	•	•	•	
15	SRE Cover	ALU-1062			•			•	•					
		ALU-1062A				•	•			•	•			

16	Nut & Washer Pkg.	90-33	•	•	•	•	•	•	•	•	•		
		8X-4075(g)											•
17	Rotor Shaft Spacer	ALH-21A	•	•									
		ALC-21F			•			•	•				
		ALD-21				•	•			•	•		
		ALU-23(f)										•	•
18	Vent Fan (2 pc.)	90-2241	•	•		•	•			•	•		
		90-2241	•	•		•	•			•	•		
		90-2259			•			•	•				
19	Drive Pulley	PU-598E	•										
		PU-672A				•				•			

- A) Bearing & Seal Pkg. Also Included With Rotor & SRE Head Assy.
- B) ALA-19S Brush Spring Set Also Available.
- C) ALE-1013AS Captive Brush & Spring Set Also Individually Available For Unit Already Having This Design. Earlier Units Must Replace The Complete Brush Holder Assy. If Brushes or Springs Are Required.
- D) XA-1026 DE Oil Seal Also Available.
- E) SRE Head & Rotor Pkg. Complete Package Must Be Used At Time of First Repair. Individual Components May Be Used Thereafter.

Contents of SRE Head & Rotor Pkg.		
SRE Head & Rotor Pkg.	90-2397	90-2398
Bearing Pkg.	90-2014	90-2014
Head Assy., SRE	ALK-1132BS-1	ALE-1142AAS-1
Rotor	ALE-2128S-1	ALU-2138S-1

- F) XA-744AZ Shaft Spacer O-Ring Seal Available.
- G) Nut Only; Washer Not Required.

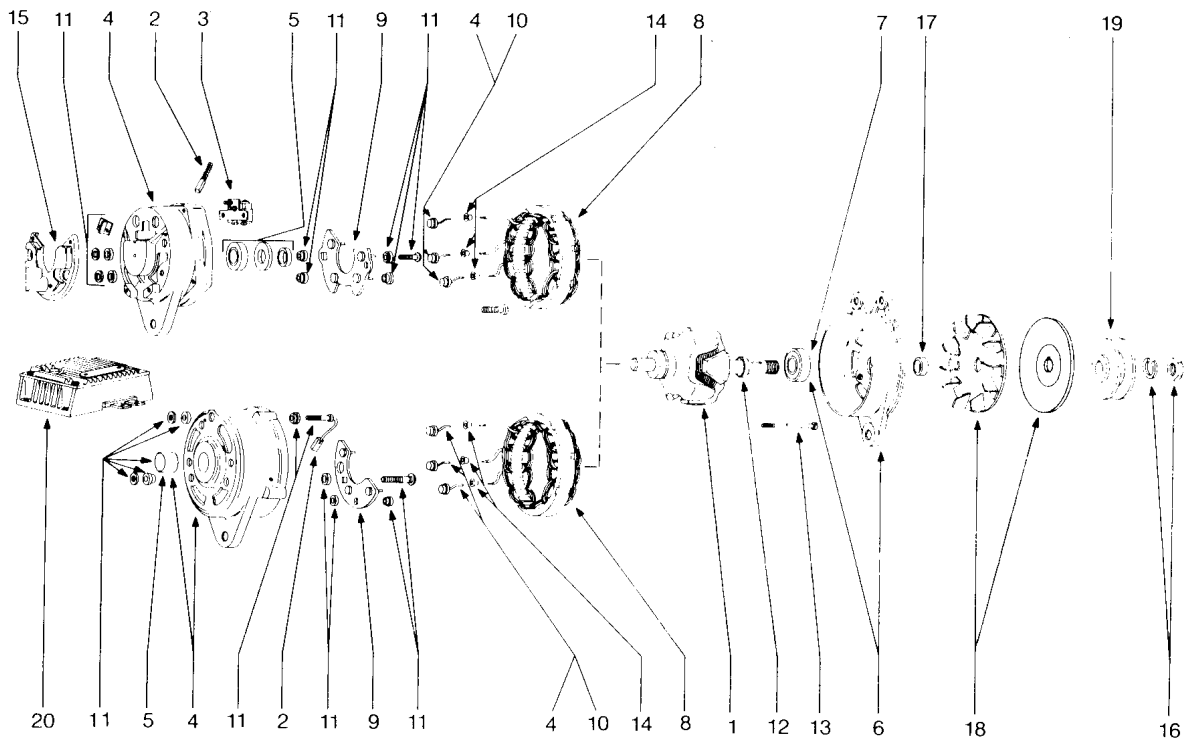

* Item 20 (Voltage Regulator) - Please See Application Chart for Voltage Regulators.