

18	Rotor Shaft Spacer	ALG-21F	•	•																	
		ALC-21F			•	•	•	•	•	•	•	•									
		ALU-23											•	•	•	•	•	•			
19	Vent Fan (2pc.)	90-2259(f)	•	•																	
		90-2241(f)			•	•	•	•	•	•	•	•									
		ALP-1034(g)											•		•		•	•	•	•	
20	Drive Pulley	PU-672A		•	•			•	•												

- A) Bearing & Seal Pkg. Also Included With Rotor & SRE Head Assy.
- B) Rotor, Bearing & Fan Assembly.
- C) ALE-1013AS Captive Brush & Spring Set Also Individually Available For Units Already Having This Design. Earlier Units Must Replace The Complete Brush Holder Assy. If Brushes or Springs Are Required.
- D) XA-1026 DE Oil Seal Also Individually Available If Required.
- E) SRE Head & Rotor Pkg. Complete Package Must Be Used At Time of First Repair. Individual Components May Be Replaced Thereafter.

Contents of SRE Head & Rotor Pkg.				
SRE Head & Rotor Pkg.	90-2399	90-2400	90-2401	90-2409
Bearing Pkg.	90-2014	90-2014	90-2014	90-2014
Head Assy., SRE	ALK-1132AS-1	ALE-1142AAS-1	ALE-1142AAS-1	ALE-1142AAS-1
Rotor	ALH-2128S-1	ALH-2138S-1	ALX-2138S-1	ALH-22065-1

- F) Two (2) Piece Fan Assy.
- G) Also Included With Rotor.
- H) Nut Only; Washer Not Required.

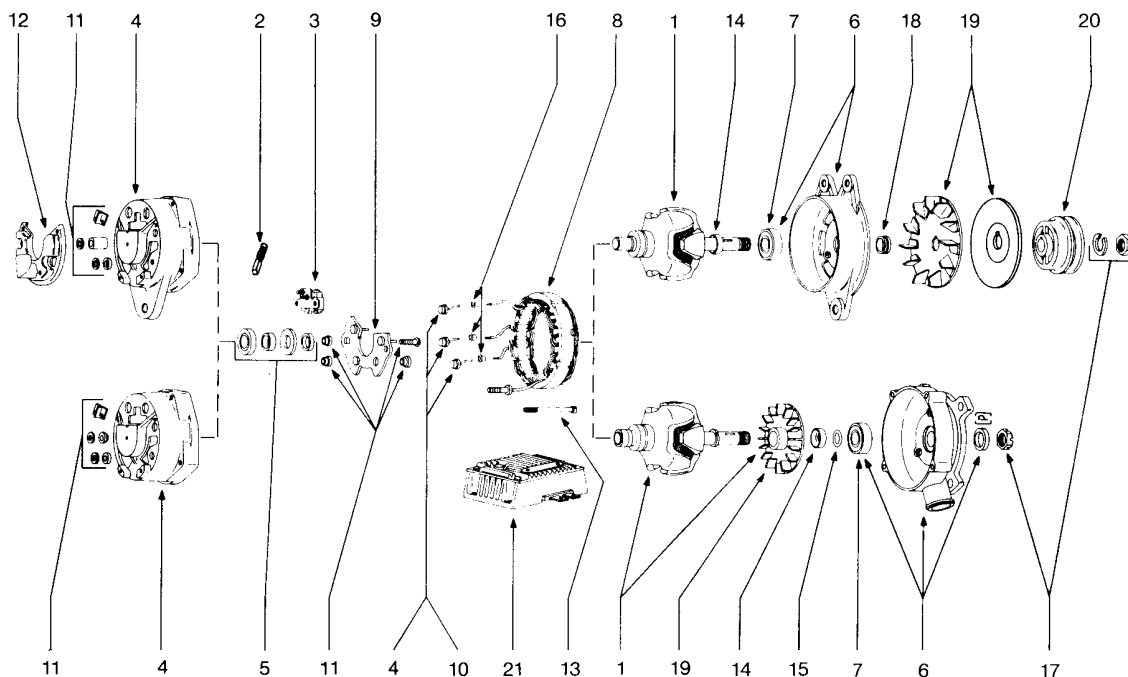

* Item 21 (Voltage Regulator) - Please See Application Chart for Voltage Regulators.