

Exploded View

No.	Description	Part No.	Assemblies				
			ALZ-8401	ALZ-8401G	ALZ-8401	ALZ-8423	ALZ-8423G
1	Rotor Assembly	90-2396(c)	•	•	•		
		ALE-2173S-1				•	•
2	Brush Set	ALE-1013AS				•	•
3	Brush Holder & Spring Asm.	ALU-1045BS(a)	•	•	•		
		ALU-1045BS				•	•
4	Slip Ring End Head Asm.	90-2396(c)	•	•	•		
		ALK-1132BS-1				•	•
5	SRE Bearing & Seal Pkg.	90-2014(b)	•	•	•	•	•
6	Drive End Head Asm.	ALE-1003K	•	•	•	•	•
7	DE Bearing	X-3416	•	•	•	•	•
8	Stator Assembly	ALE-2008AG	•	•	•	•	•
9	Pos. Rectifier & Plate Asm.	ALE-1054A	•	•	•	•	•
10	Negative Rectifier (Pkg. Of 3)	XA-944JS	•	•	•	•	•
11	SRE Cover	ALU-1062A	•	•	•	•	•
12	DE Retainer	GR-32	•	•	•	•	•
13	Term Stud Package	90-2030	•	•	•	•	•
14	Thru Bolt Package	ALA-20JS	•	•	•	•	•
15	Eyelet Package	90-818	•	•	•	•	•
16	Nut & Washer Package	90-33	•	•	•	•	•
17	Rotor Shaft Spacer	ALD-21	•	•	•	•	•
18	Vent Fan (2 pc.)	90-2241	•	•	•	•	•
19	Drive Pulley	PU-672A	•	•	•	•	•

- A) ALE-1013AS Captive Brush & Spring Set Also Individually Available For Unit Already Having This Design. Earlier Units Must Replace The Complete Brush Holder Assy. If Brushes or Springs Are Required.
- B) Bearing & Seal Pkg. Also Included With Rotor & SRE Head Assy.
- D) SRE Head & Rotor Pkg. Complete Package Must Be Used At Time of First Repair. Individual Components May Be Used Thereafter.

Contents of SRE Head & Rotor Pkg.	
SRE Head & Rotor Pkg.	90-2396
Bearing Pkg.	90-2014
Head Assy., SRE	ALK-1132BS-1
Rotor	ALE-2173S-1

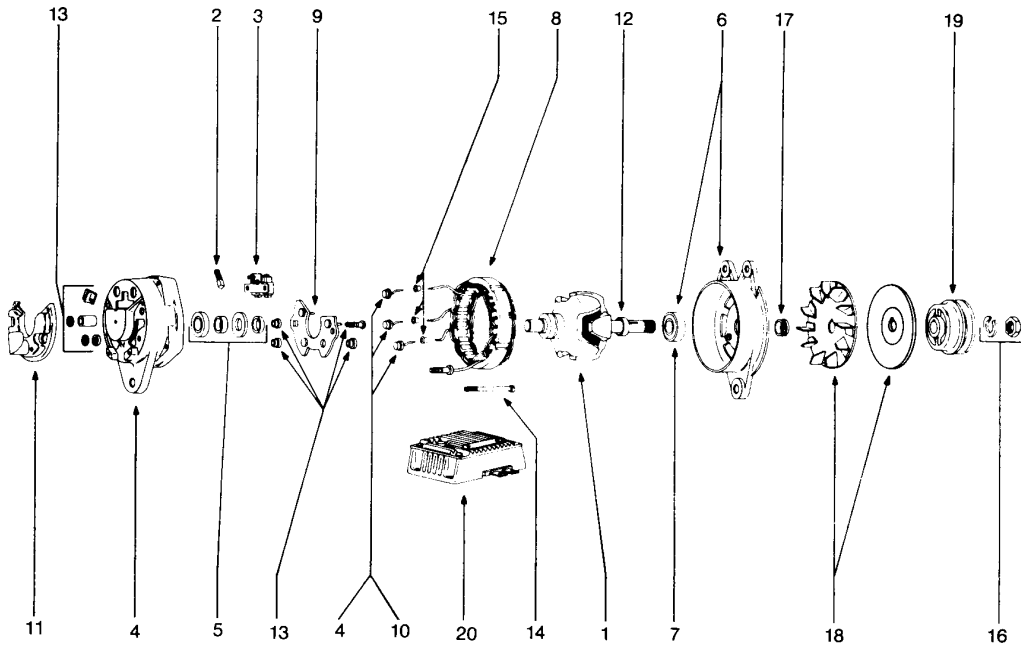

* Item 20 (Voltage Regulator) - Please See Application Chart For Voltage Regulators.