

Exploded View

ANG Alternator

Assemblies

No.	Description	Part No.	ANG-6401	ANG-6402	ANG-6423	ANG-6423S
1	Rotor Assembly	90-2403(a)	•	•		
		ANG-2128S-1			•	•
2	Brush Set	ALE-1013AS	•	•	•	•
3	Brush Holder & Spring Assy.	ALU-1045BS	•	•	•	•
4	Slip Ring End Head Assy.	90-2403(a)	•	•		
		ALK-1132S-1			•	•
5	SRE Bearing & Seal Pkg.	90-2014(b)	•	•	•	•
6	Drive End Head Assy.	ALE-1003R	•	•	•	•
7	DE Bearing	X-3416	•	•	•	•
8	Stator Assembly	ALE-2008AH	•	•	•	•
9	Pos. Rectifier & Plate Assy.	ALE-1054A	•	•	•	•
10	Negative Rectifier (Pkg. Of 3)	XA-944JS	•	•	•	•
11	Term. Stud & Parts Pkg.	90-2043	•	•	•	•
12	DE Retainer	GR-37	•	•	•	•
13	Eyelet Package	90-818	•	•	•	•
14	Thru Bolt Package	ALA-20GS	•	•	•	•
15	Nut & Washer Package	90-33	•	•	•	•
16	Rotor Shaft Spacer	ALC-21F	•	•	•	•
17	Vent Fan (2 pc.)	90-2259	•	•	•	•

- A) SRE Head & Rotor Pkg., Complete Pkg. Must Be Used At Time Of First Repair. Individual Components May Be Replaced Thereafter.

Contents of SRE Head & Rotor Package	
SRE Head & Rotor Pkg.	90-2403
Bearing Package	90-2014
Head Assy., SRE	ALK-1132AS-1
Rotor	ANG-2128S-1

- B) Bearing & Seal Pkg., Also Included With Rotor & SRE Head Assy.

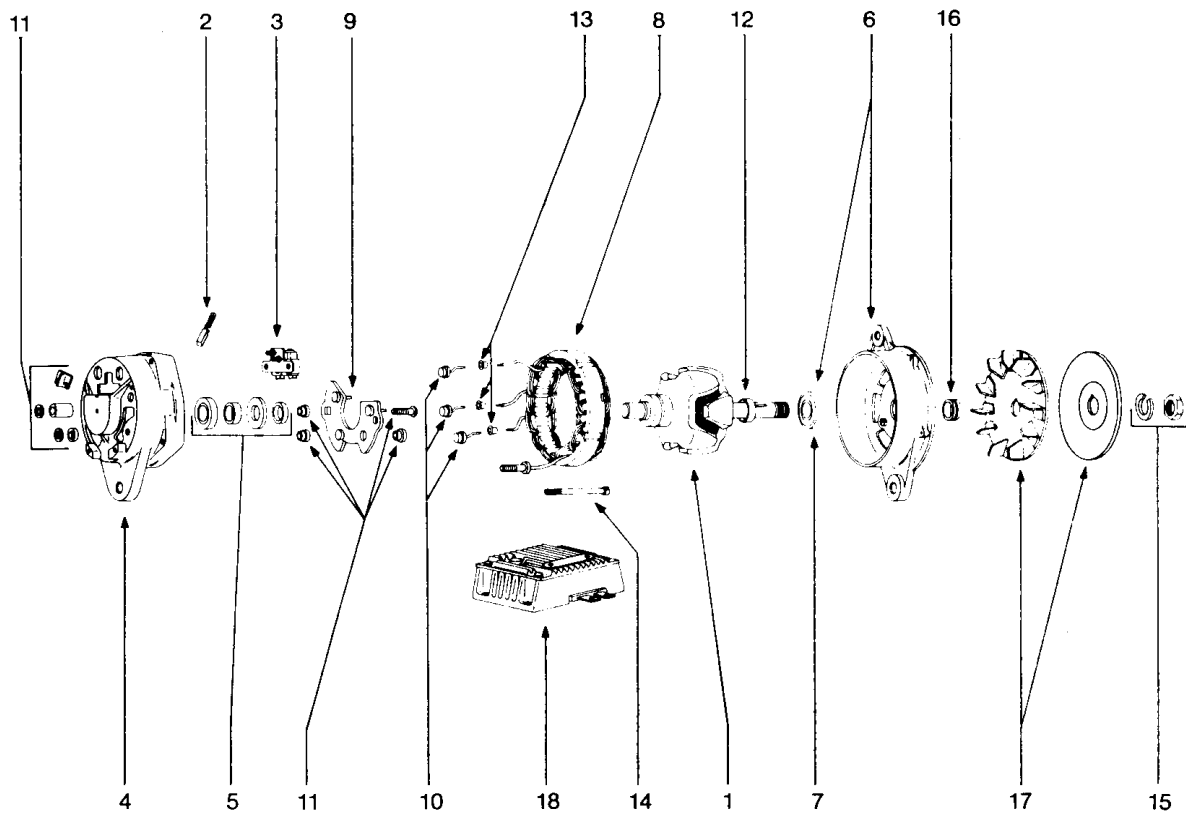

* Item 18 (Voltage Regulator) - Please See Application Chart for Voltage Regulators.